

# Women in Leadership Rise & Lead

EXPLORE | ENGAGE | EMPOWER



August 05 – 07, 2025



City Campus, IBA Karachi

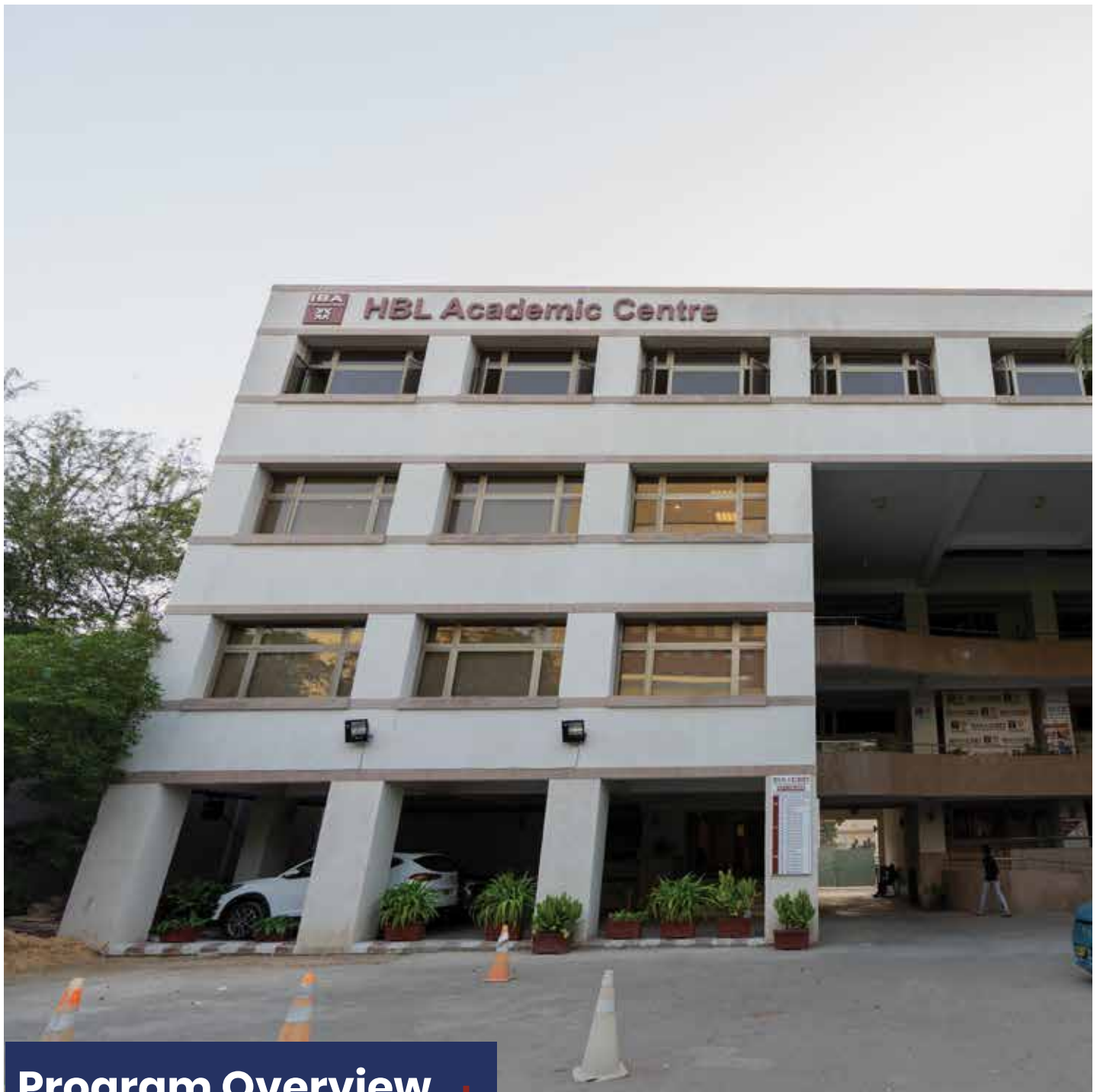

## Program Overview

This 3-day workshop is designed for women professionals to explore their hidden strengths and create their identity, leadership style, and a career model tailored to their personal and professional needs. The program will empower women to develop the critical skills they need to advance in their careers as talented and self-motivated leaders. It will also provide a platform to engage and learn from one another, in addition to meeting senior professionals who will serve as role models by sharing their journeys, experiences, and expertise. The woman-to-woman setting is essential to encourage, support, and sponsor aspiring women leaders, and to equip them with the knowledge, skills, and abilities unique to women—elements that may not be effectively addressed in a mixed-gender program.

# PROGRAM LEARNING OUTCOMES

## Module 1: EXPLORE

- Critically analyze how thoughts, feelings, and behaviors influence both work and life.
- Enhance self-awareness by identifying gaps in capabilities and recognizing natural strengths at a deeper level in order to leverage them effectively.

## Module 2: ENGAGE

- Articulate ideas confidently and clearly to build rapport, convey authority, and influence others positively to build trust. Adapt communication and influencing styles to suit different contexts. Recognize gender dynamics in managing situations or conflict by negotiating confidently using various negotiating strategies, and expand and leverage personal and professional networks for career advancement.

## Module 3: EMPOWER

- Learn and apply strategies to create a personal brand and develop a distinctive leadership identity aligned with one's ambitions, values, and goals. Create a personalized career progression plan by developing short and long-term goals along with concrete measures and actions to achieve them.





# Course Outline

- Discovering oneself to shape a unique identity and leadership style
- Identifying barriers to career advancement
- Learning to communicate effectively
- Building and leveraging professional networks
- Developing a personalized career model
- Negotiating and care-fronting to support career growth



## Trainers Profile



### **Dr. Lalarukh Ejaz**

Director, Centre for Entrepreneurial Development (IBA CED) and Assistant Professor, School of Business Studies, IBA Karachi



### **Dr. Nyla Ansari**

Assistant Professor, School of Business Studies, IBA Karachi



### **Ms Maheen Ghauri**

Dean Student Affairs, IBA Karachi

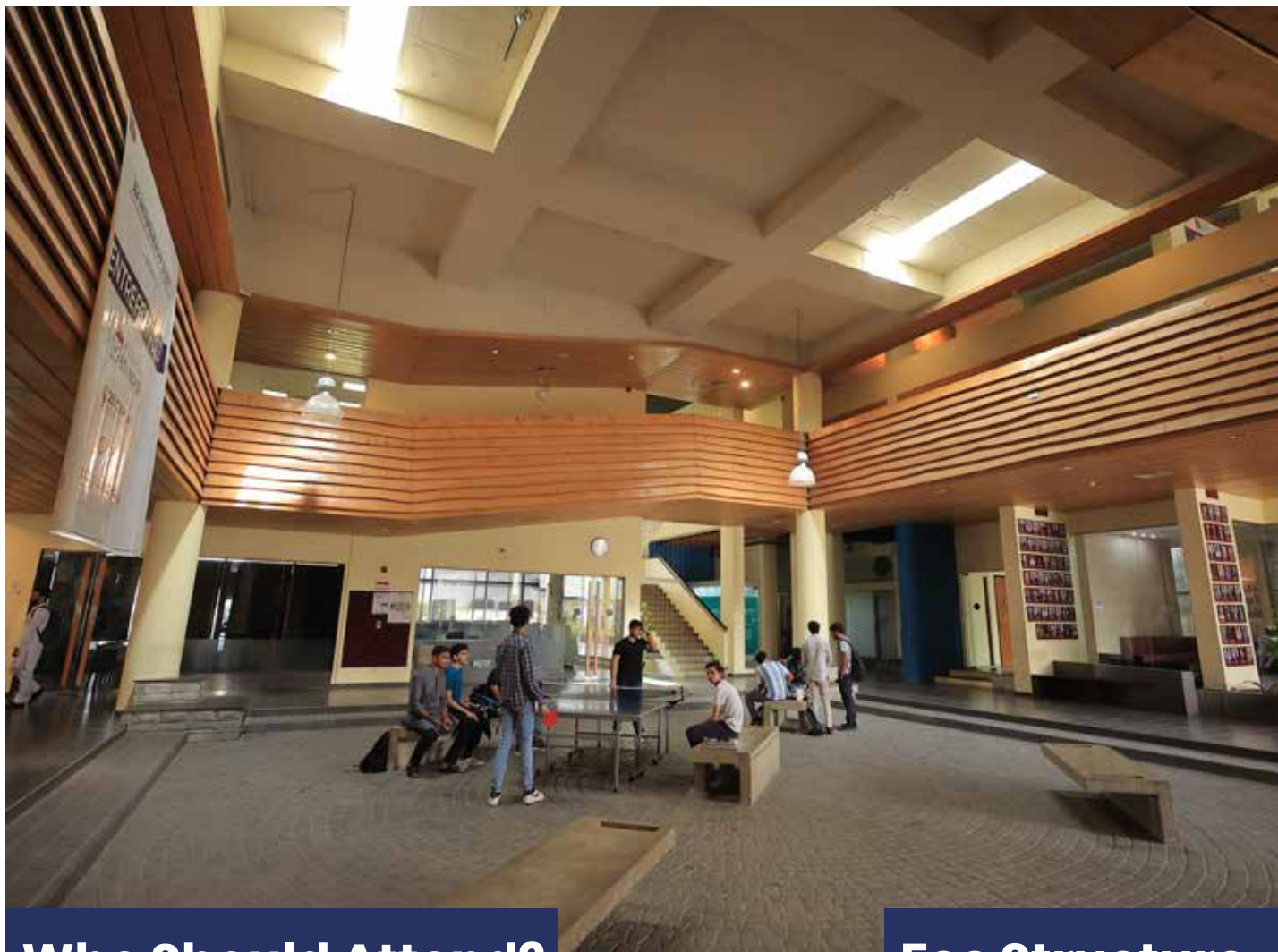

## Who Should Attend?

Middle-level women managers with 3+ years of team management experience.

## Fee Structure

**PKR 270,000/-** (plus 5% SST)



For Registration

**SCAN  
HERE**

## Contact Us



[cee.iba.edu.pk](http://cee.iba.edu.pk)



[ceeinfo@iba.edu.pk](mailto:ceeinfo@iba.edu.pk)



021-38104701 | 1809, 1812



Plot # 68 & 88 Garden Kiyani Shaheed Road,  
Karachi, Sindh, Pakistan



@ceeatiba